

LS100

SINGLE STAGE LOUVRE

- Offsite prototype tested to:
 - AS 4740:2000 Natural ventilators
- Developed by a team of expert designers, manufacturers and installers specifically for the Australian market.
- Extruded and manufactured in Melbourne.
- Fast lead times.
- Low carbon footprint.
- For system details please contact Spective.

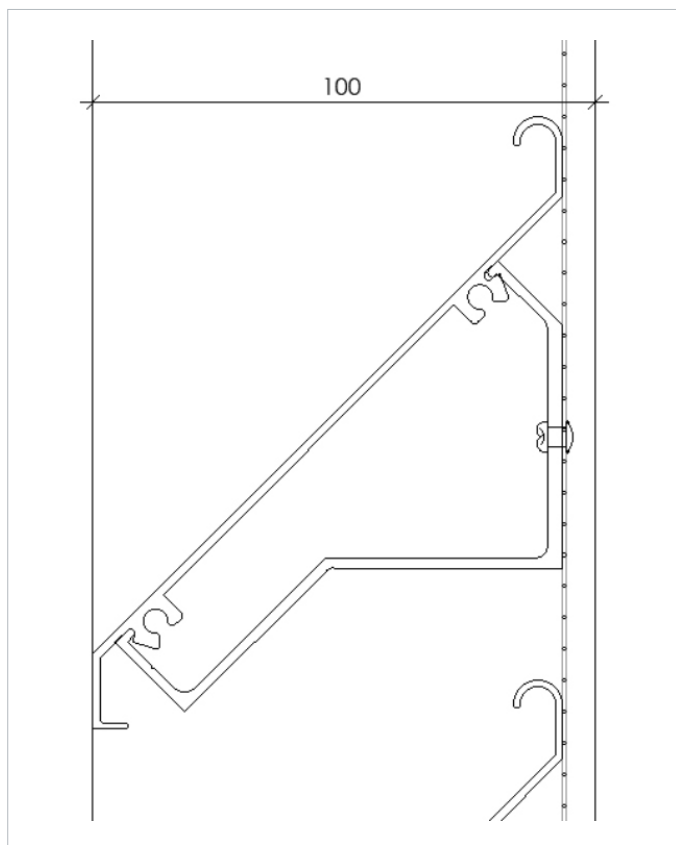

LS100 Single stage louvre

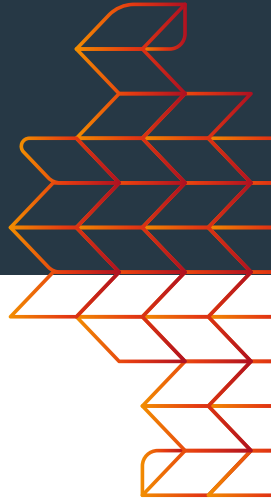

LS200

DOUBLE STAGE LOUVRE

- Offsite prototype tested to:
 - AS 4740:2000 Natural ventilators
- Developed by a team of expert designers, manufacturers and installers specifically for the Australian market.
- Extruded and manufactured in Melbourne.
- Fast lead times.
- Low carbon footprint.
- For system details please contact Spective.

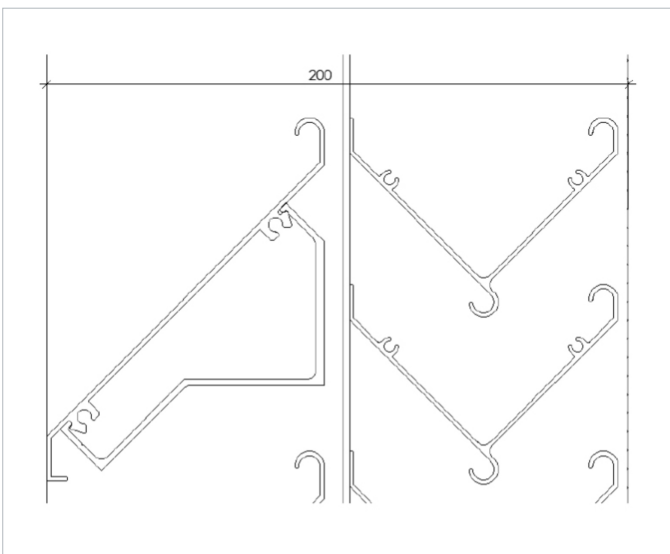

LS200 Double stage louvre

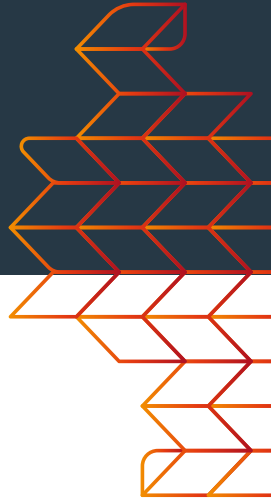

LV200

DOUBLE STAGE VERTICAL LOUVRE

- Off-site prototype tested to:
 - AS 4740:2000 Natural ventilators
- Developed by a team of expert designers, manufacturers and installers specifically for the Australian market.
- Extruded and manufactured in Melbourne.
- Fast lead times.
- Low carbon footprint.
- For system details please contact Spective.

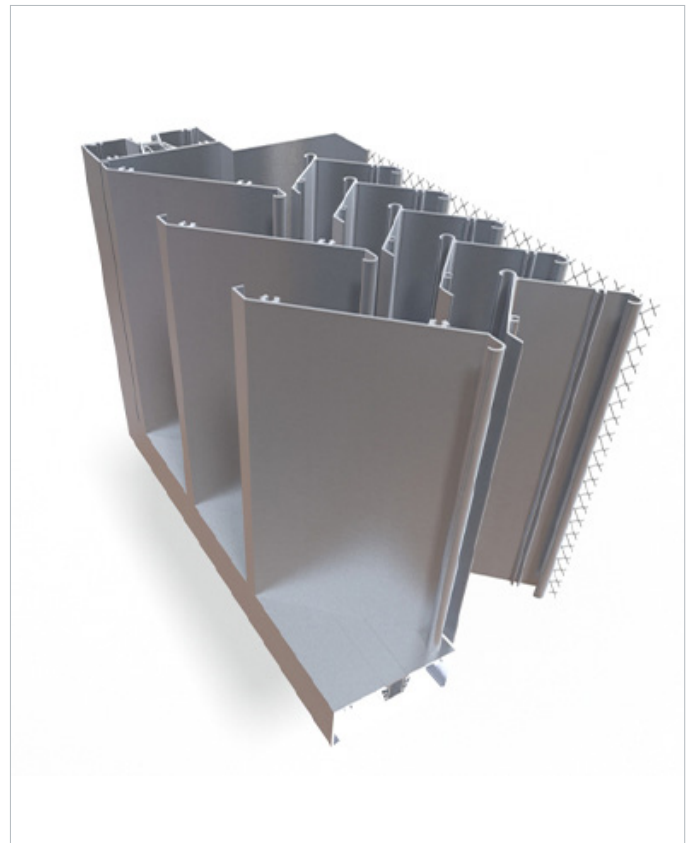
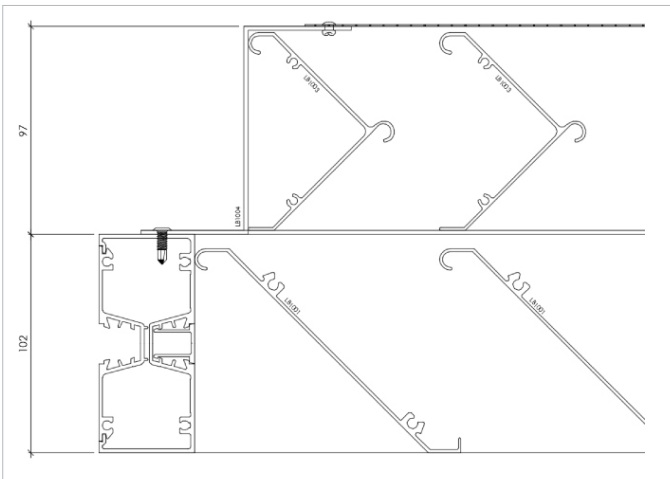

LV200 Double Stage Vertical Louvre

LS100, LS200 & LV200 LOUVRE PROFILE

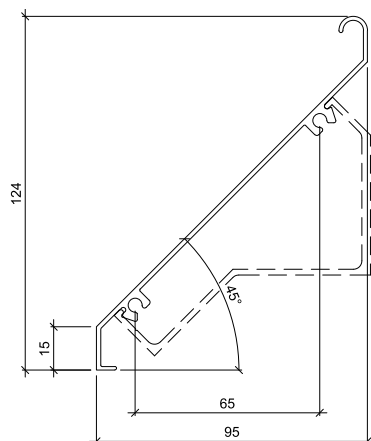

LOUVRE BLADE
CODE: LB1001
MASS Kg/M: 0.9
AP: 405
STRUCTURAL ALLOY: 6005 T5

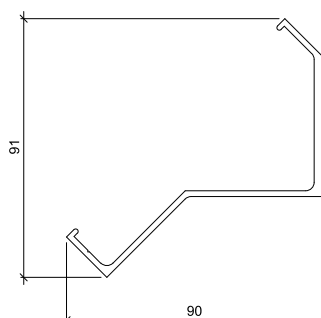

LOUVRE BLADE CLIP
CODE: LB1002
MASS Kg/M: 1.1
AP: 351
ALLOY: 6060 T5

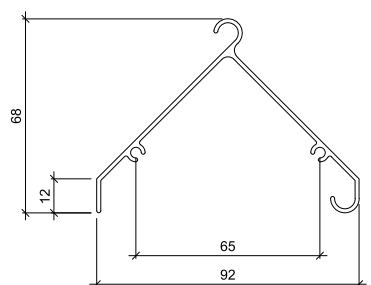

TRI LOUVRE BLADE
CODE: LB1003
MASS Kg/M: 0.8
AP: 389
STRUCTURAL ALLOY: 6005 T5

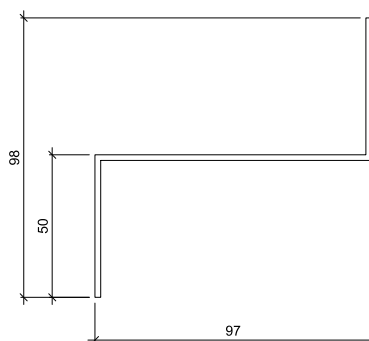

LOUVRE FRAME
CODE: LB1004
MASS Kg/M: 1.0
AP: 390
ALLOY: 6060 T5

LS100 SINGLE STAGE LOUVRE ASSEMBLY

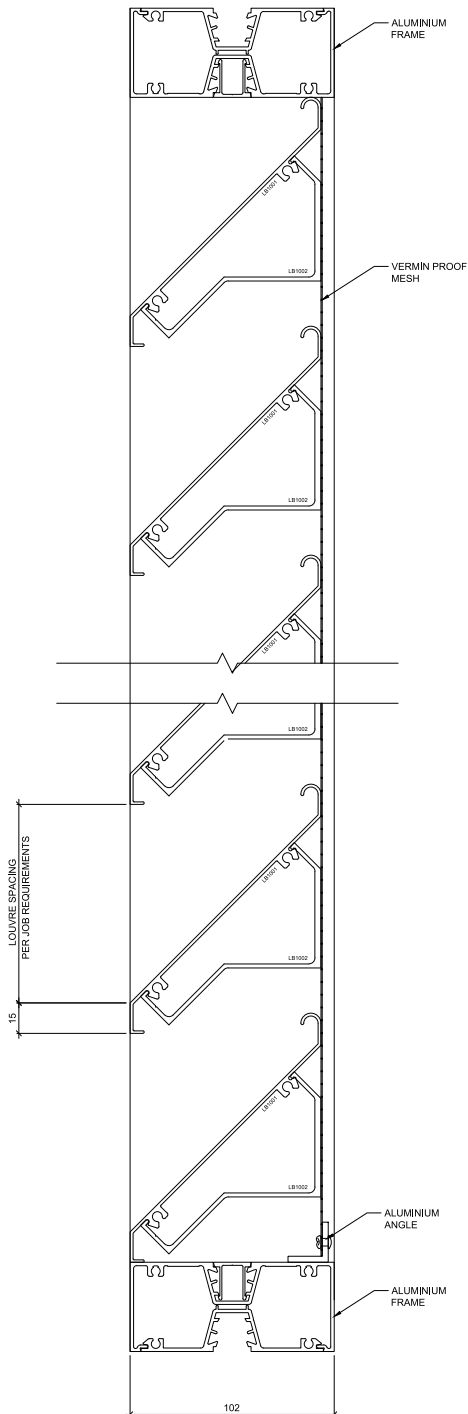

LS200 DOUBLE STAGE LOUVRE ASSEMBLY

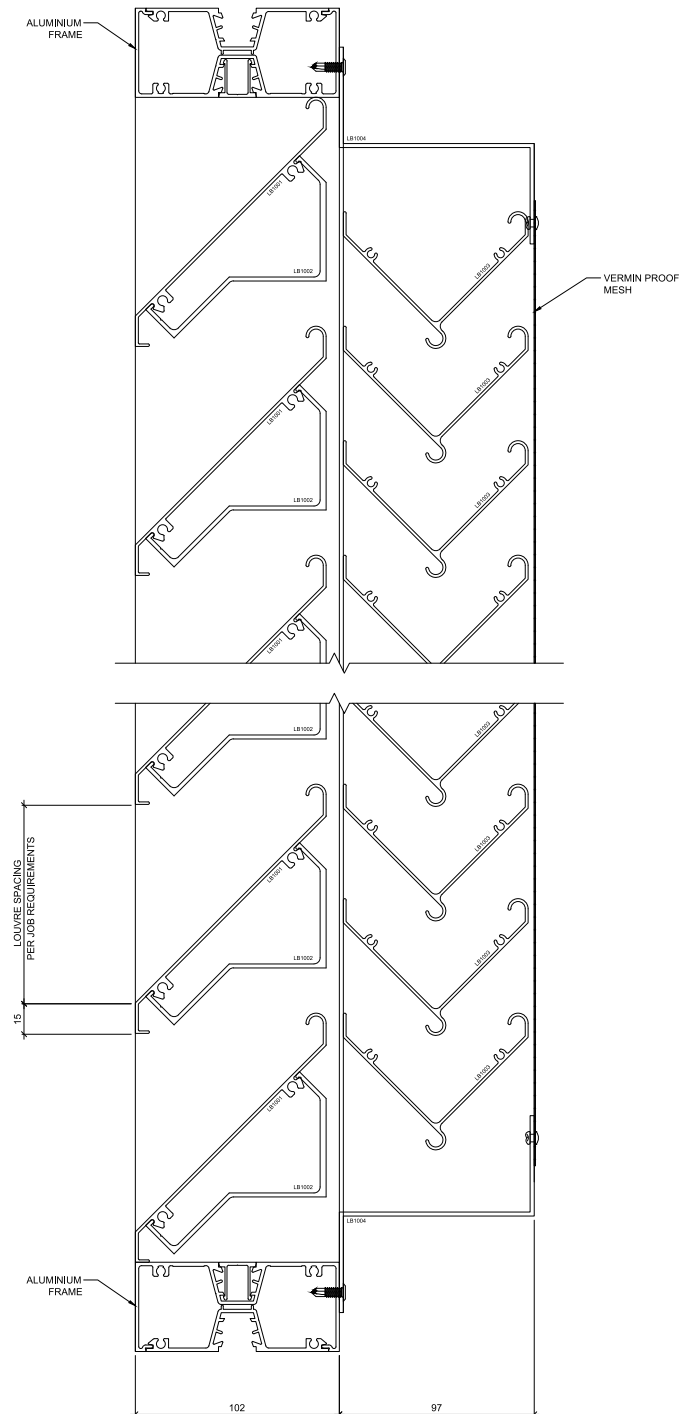

LV200 DOUBLE STAGE VERTICAL LOUVRE ASSEMBLY

55% FREE AREA

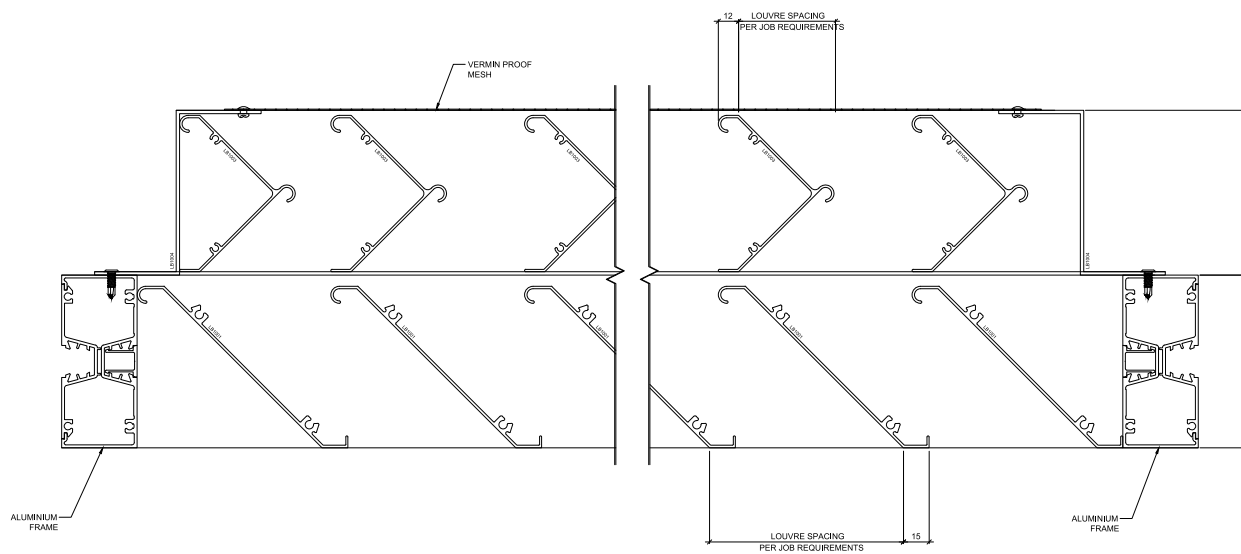

40% FREE AREA

